

Fusibili P / Fuses P

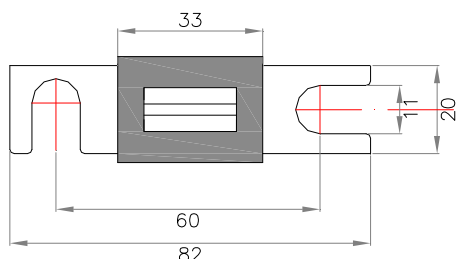

Applicazioni:

-Fusibili per trazione
carrelli industriali ed elevatori

Applications:

-Fuses for battery powered
industrial trucks and elevators

Descrizione / Description	Valore / Value
Passo / Fixing centres	60 mm.
Caratteristica / Characteristic	F=rapido / F=fast
Tensione / Voltage	80 Vdc

Corrente nominale I_n / Test current	1,5x I_n	1,8x I_n	2x I_n
	>1h	>1h	0,8 – 4s

Corrente nominale / Rated current	Materiale / Material
35-50-63-80 A	Zinco / Zinc
100-125-160-200-250 A	Rame Nichelato / Nichel plated Copper

Descrizione	Codice	Descrizione	Codice	Descrizione	Codice
Description	Code	Description	Code	Description	Code
Fuse 35A P	571000-00	Fuse 125A P	571005-00	Fuse 350A P	571010-00
Fuse 50A P	571001-00	Fuse 160A P	571006-00	Fuse 400A P	571011-00
Fuse 63A P	571002-00	Fuse 200A P	571007-00	Fuse 450A P	571012-00
Fuse 80A P	571003-00	Fuse 250A P	571008-00	Fuse 500A P	571013-00
Fuse 100A P	571004-00	Fuse 300 P	571009-00	-	-